

NEXUS 7-Speed Internal Hub w/Coaster Brake

SG-C3000-7C

SG-C3000-7C-DX

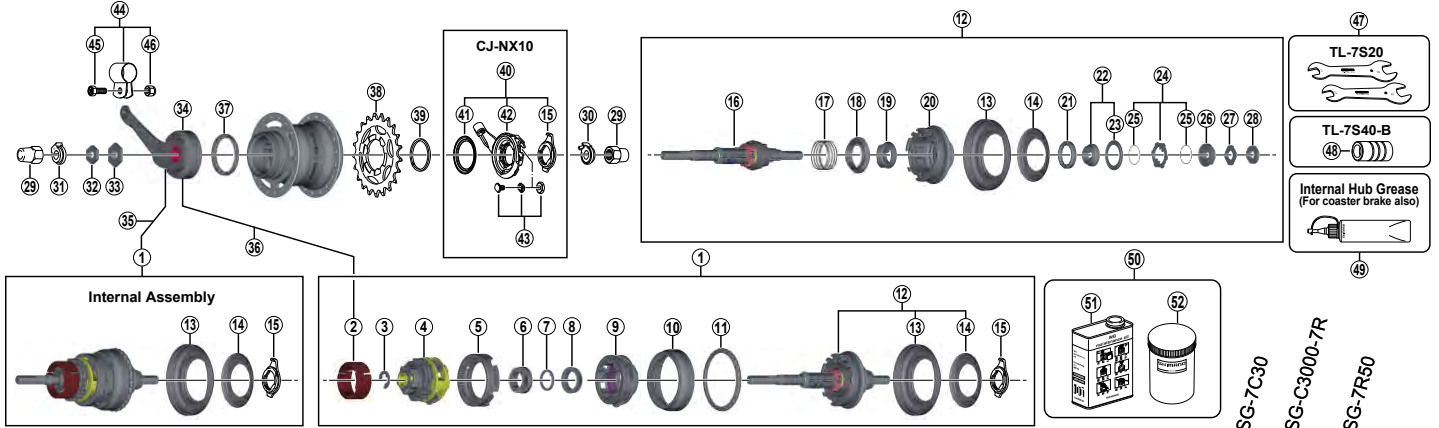

ITEM NO.	SHIMANO CODE NO.	DESCRIPTION	INTERCHANGEABILITY		
1	Y38R98010	Internal Assembly (Axle Length 175.5 mm) for SG-C3000-7C		B	
	Y38R98020	Internal Assembly (Axle Length 175.5 mm) for SG-C3000-7C-DX		B	
	Y38R98030	Internal Assembly (Axle Length 184 mm) for SG-C3000-7C-DX			
2	Y38R98040	Brake Shoe Unit			
3	Y32532000	Stop Ring (ø9 mm)		A	
4	Y38R98050	Carrier Unit 2			
5	Y35K98040	Ring Gear Unit 2		A	
6	Y38R09000	Sun Gear 3			A
7	Y38R11000	Sun Gear Guide Ring 2			A
8	Y38R08000	Sun Gear 2			A
9	Y38P98050	Carrier Unit 1			A
10	Y35K98050	Ring Gear Unit 1		A	
11	Y38R98060	Ball Retainer H (3/16" x 29)			A
12	Y38R98070	Axle & Driver Unit (Axle Length 175.5 mm) w/Right Hand Dust Cap B & C for SG-C3000-7C			
	Y38R98080	Axle & Driver Unit (Axle Length 175.5 mm) w/Right Hand Dust Cap B & C for SG-C3000-7C-DX			
	Y38R98090	Axle & Driver Unit (Axle Length 184 mm) w/Right Hand Dust Cap B & C for SG-C3000-7C-DX			
13	Y35B05000	Right Hand Dust Cap B for SG-C3000-7C		A	
	Y35K06000	Right Hand Dust Cap B for SG-C3000-7C-DX		A	
14	Y33Z26000	Right Hand Dust Cap C		A	A
15	Y33Z98020	Cassette Joint Fixing Ring		A	A
16	Y38R98100	Axle Unit (Axle Length 175.5 mm)			
17	Y38R98110	Axle Unit (Axle Length 184 mm)			
18	Y33024000	Return Spring A		A	A
19	Y33Z10000	Gear Shifting Cam		A	A
20	Y33Z11000	Feed Cam		A	A
21	Y35K98080	Driver Unit		A	
22	Y33091600	Ball Retainer F (3/16" x 12)		A	A
23	Y35K98100	Right Hand Cone w/Seal		A	A
24	Y35K07000	Right Hand Cone Seal		A	A
25	Y33F98040	Driver Plate w/Seal		A	A
26	Y33012000	Driver Plate Seal		A	A
27	Y33E98120	Lock Washer		A	A
28	Y33Z08000	Stop Washer		A	A
29	Y33Z07020	Right Hand Lock Nut (3.4 mm)		A	
30	Y31414010	Cap Nut (3/8")		A	A
31	Y33Z20500	Non-turn Washer 5R (Yellow)		A	A
	Y33M39600	Non-turn Washer 6R (Silver)		A	A
	Y33M39700	Non-turn Washer 7R (Black)		A	A
	Y33M39510	Non-turn Washer 5L (Brown)		A	A
32	Y33M39610	Non-turn Washer 6L (White)		A	A
	Y33M39710	Non-turn Washer 7L (Gray)		A	A
	Y32138040	Lock Nut (3.5 mm)		A	
33	Y33548110	Stop Nut		A	
34	Y38R98120	Brake Arm Unit for SG-C3000-7C			
	Y38R98130	Brake Arm Unit for SG-C3000-7C-DX			
35	Y38R98140	Internal Assembly (Axle Length 175.5 mm) & Brake Arm Unit for SG-C3000-7C		B	
	Y38R98150	Internal Assembly (Axle Length 175.5 mm) & Brake Arm Unit for SG-C3000-7C-DX		B	
	Y38R98160	Internal Assembly (Axle Length 184 mm) & Brake Arm Unit for SG-C3000-7C-DX			
36	Y38R98170	Brake Shoe Unit & Brake Arm Unit for SG-C3000-7C		B	
	Y38R98180	Brake Shoe Unit & Brake Arm Unit for SG-C3000-7C-DX		B	
37	Y38R98190	Ball Retainer B (3/16" x 16)		A	
	Y32203220	Sprocket Wheel 16T (Silver)		A	A
	Y32203420	Sprocket Wheel 18T (Silver)		A	A
	Y32203520	Sprocket Wheel 19T (Silver)		A	A
	Y32203620	Sprocket Wheel 20T (Silver)		A	A
	Y33060000	Sprocket Wheel 21T (Silver)		A	A
	Y33060100	Sprocket Wheel 22T (Silver)		A	A
	Y33060200	Sprocket Wheel 23T (Silver)		A	A
38	Y32120100	Snap Ring C		A	A
39	Y74Y98050	CJ-NX10 Cassette Joint Unit		A	A
40	Y74Y18000	Driver Cap		A	A
41	Y74Y93100	CJ-NX10 Cassette Joint		A	A
42	Y74Y98060	Inner Cable Fixing Bolt Unit		A	A
43	Y33F98090	Brake Arm Clip Unit (5/8")		A	A
44	Y75M06000	Clip Screw (M6 x 16)		A	A
45	Y31727200	Clip Nut		A	A
46	Y13098900	TL-7S20 Hub Spanner (17 mm x 22 mm) 2 pcs.		A	A
47	Y30889000	TL-7S40-B Right Hand Cone Tool		A	A
48	Y04120800	Internal Hub Grease (Net. 100g)		A	A
49	Y00298010	WB maintenance oil set		B	B
50	Y00201000	WB maintenance oil (1L)		B	B
51	Y00201100	Bottle		B	B

A: Same parts.

B: Parts are usable, but differ in materials, appearance, finish, size, etc.

Absence of mark indicates non-interchangeability.

Sep.-2014-3724

© Shimano Inc.H